

TEMPLATE READY CHECKLIST

iWORKTOPS

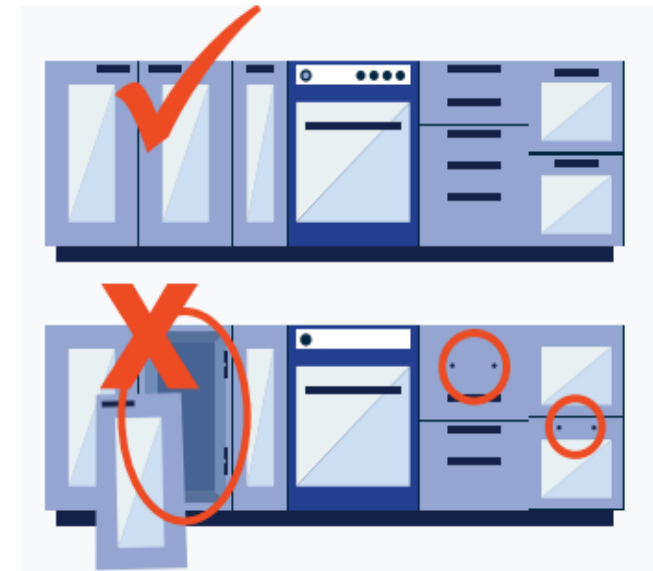

1.

**All existing worktop; must
be removed prior to the
template date**

All worktop; must be clear

2.

**All base cabinet; draw; must
be completely installed in
final position, level, flush
and fixed to the wall; before
we template**

3.

**All end Panel; handle;,
finish trim; must be in place
prior to templating**

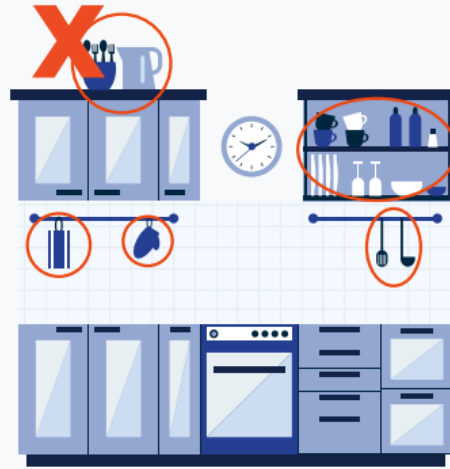
iWORKTOPS

Failure to meet these conditions may result in additional charges and a delay if a return visit is required

TEMPLATE READY CHECKLIST

iWORKTOPS

Things to remember



A Homeowner or authorised designated representative 18 years or older must be present during the entire template process, this person will need to sign off on final dimensions and specification

We will not proceed without this person of authority present, the appointment will be rescheduled and an additional charge will be incurred



After templating, no details can be changed

If you require confirmation of the installation date please check with the office not the templater

Payment of any balance due must be paid by 10am the day after template to ensure no delay



Parking must be provided by the customer on the day of template and on the installation day



Any changes at point of template from the order specification will result in a change to cost, this will be confirmed by the office the next day.

Works will not proceed until balance is received by the office

TEMPLATE READY CHECKLIST

iWORKTOPS

1

A homeowner or designated representative 18 years or older must be present during the entire template/installation process. This person must be authorised to approve all work to be completed

2

Parking must be provided by customer on template and installation day. If we are asked to stop work due to noise requirements, hours or other restrictions, an additional charge for revisit will apply

3

Prior to installation customer must cover anything they want to protect, the installation process will result in some dust.

Access to water and electricity in the home is required

4

Customer must ensure there is sufficient space through doors or openings for worktops to fit, all paths must be clear of obstructions, worktops are heavy and require a clear safe path during installation

5

All appliances should be in final location before template, all carcasses and end panels fixed in final location, all sinks, hobs, taps, pop up sockets and anything to go into the worktop must be available at the point of template

6

Any debris created by the installer/template will be removed and disposed of , homeowner is responsible for any debris removal and disposal not created by the fabricator

7

All old worktops must be removed before template/installation, all plumbing, hobs electric sockets if full height splashbacks, must be disconnected prior to installation

8

All sinks/hobs must be made available to the templater for precise cutting Please note without sink and hobs on template we cannot proceed

9

Ranges and any free standing appliance should be in final location for template to ensure accurate measurements are available

10

Homeowner must secure all pets prior to template and installation as we will need to go in and out to the vehicle and leave doors open when we carry large pieces into the property

11

Undermount Sinks will need to be resealed with silicone after the plumbing is attached as plumbing the sink in can move the sink and break the seal this is the homeowners responsibility to arrange

12

The Fabricator is not responsible for installation of support, support brackets, for support of overhangs, any carpentry work, and electrical or plumbing work